

FORM No. 1.

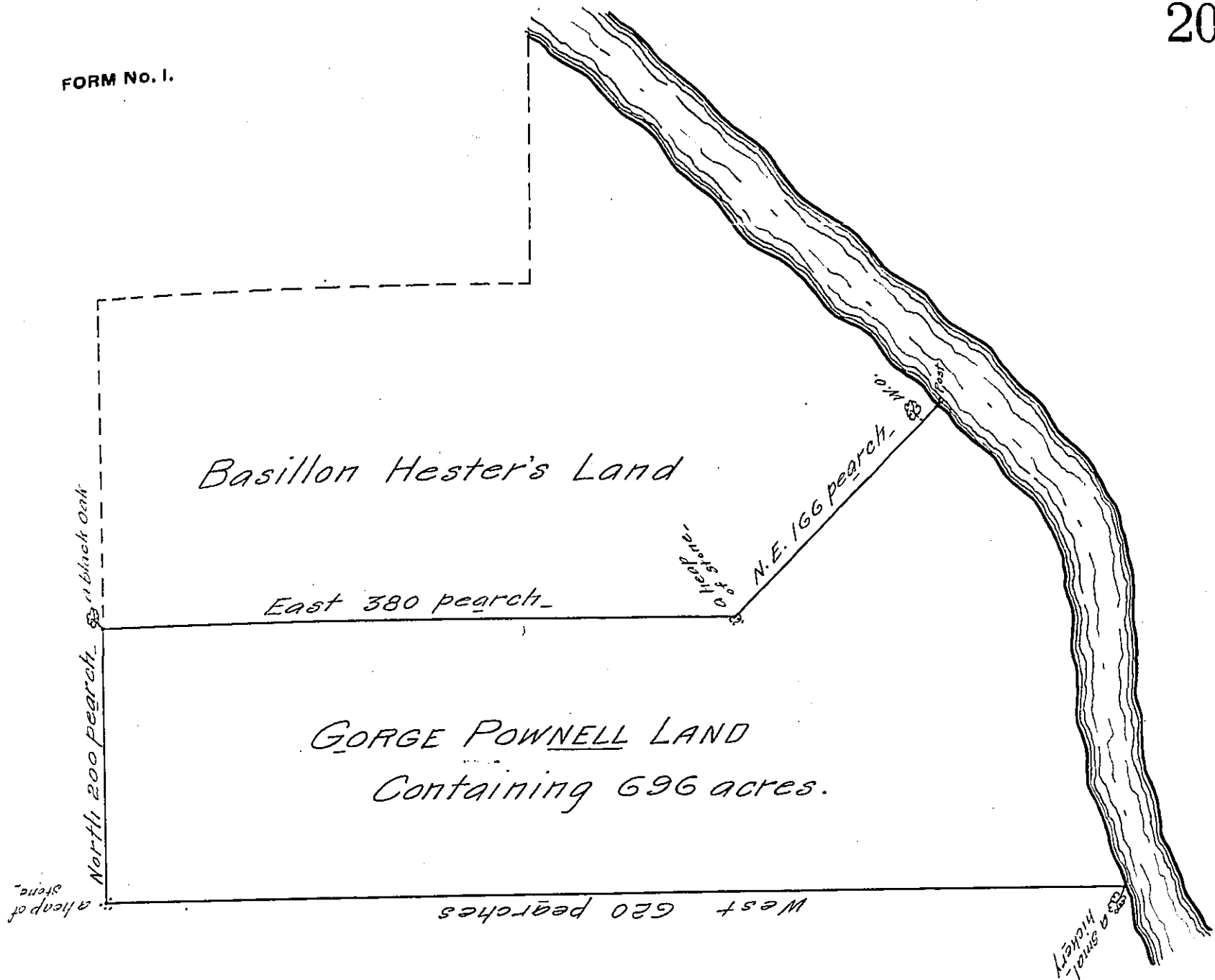

Resurveyed This Tract of Land By verty of a Warrant from Beneman Eastbourn Surveral Genral to me drected bering date the fourtenth day of may Ano dom: 1740 Begining at a smal Hickry standing by the side of dalawar River then west Six hundred and twenty perches by land lot Randal Spikman to a heap of Stone then North two hundred perches by the said Spikman's Land to a black oak then East by Basillon Hester's Land three hundred and Eighty perches to a heap of Stone then north East one hundred and sixty six perch to a post by a whit oak on the top of the bank of the River Dalaware ~~then~~ then down the sevral Corses of the said River to the place of begining Containing Six hundred and ninty six acres of land Resurveyed in august 1741 by
John Chapman d: S.

This is the anshent bounds as neer as I can find and I beleve it is acording to the first Survey of this tract. J. C.
IN TESTIMONY that the above is a copy of the original remaining on file in the Department of Internal Affairs of Pennsylvania, made conformably to an Act of Assembly approved the 16th day of February, 1833, I have hereunto set my Hand and caused the Seal of said Department to be affixed at Harrisburg, this twenty-ninth day of October 1906

Loose J. Brown
Secretary of Internal Affairs.